

Installation and Operation Instructions



CE 2531-23

Pin Code: 2531D0-0011

Model : YF-8863(G)
Appliance name : Portable gas grill

Important information: Please carefully read this instruction manual to familiarize yourself with the equipment before connecting to the gas tank. Please keep this instruction manual for reference.

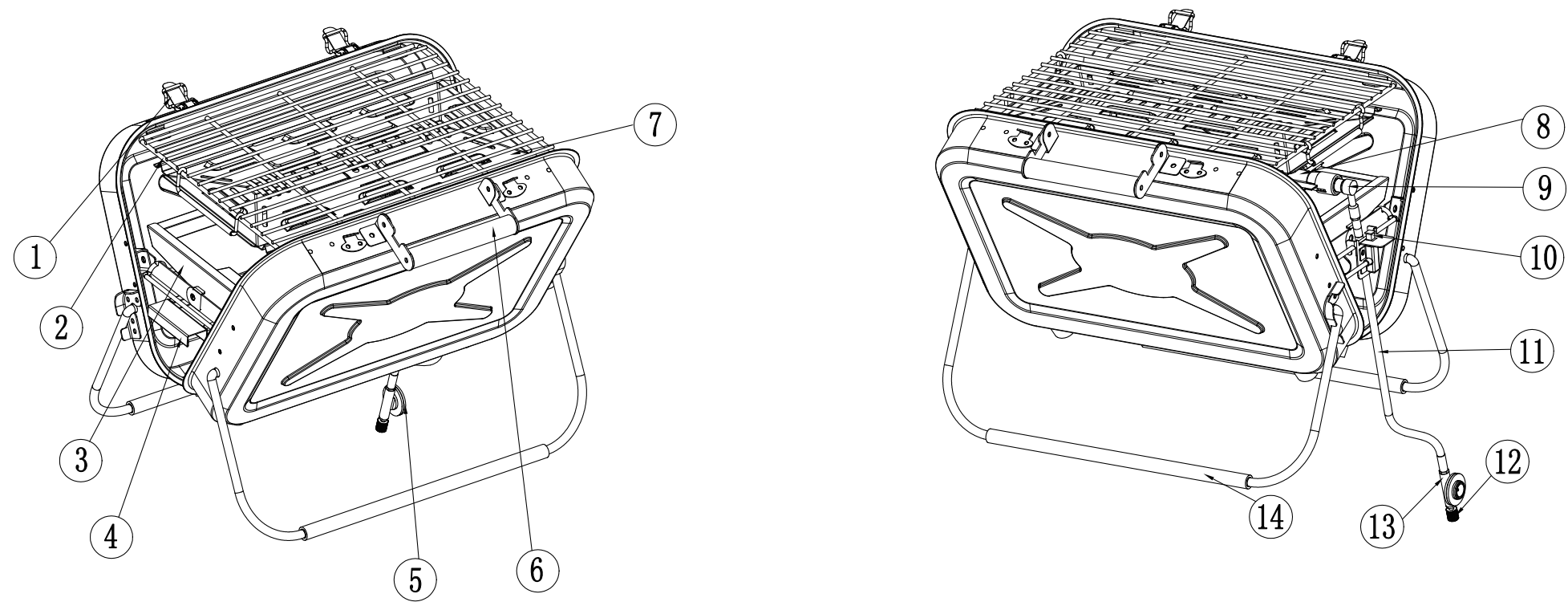

- | | | | |
|------------------------|-------------------|--------------------|-----------------|
| 1 Lock assembly | 5 Sealing gasket | 9 Valve assembly | 13 Gas joint |
| 2 cooking grid | 6 Handle assembly | 10 Ignition button | 14 Furnace foot |
| 3 Air circuit assembly | 7 Fire baffle | 11 Flexible hose | |
| 4 Oil receiving box | 8 Burner | 12 Control knob | |

FIG1

Remove all outer packing off the grill

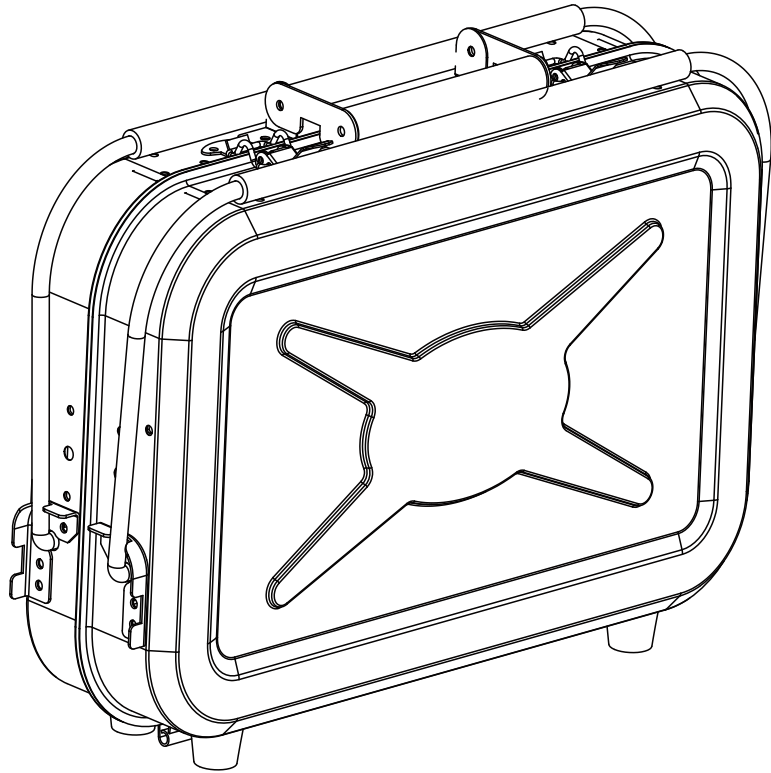

FIG2

Unlock the buckles where the arrow indicates

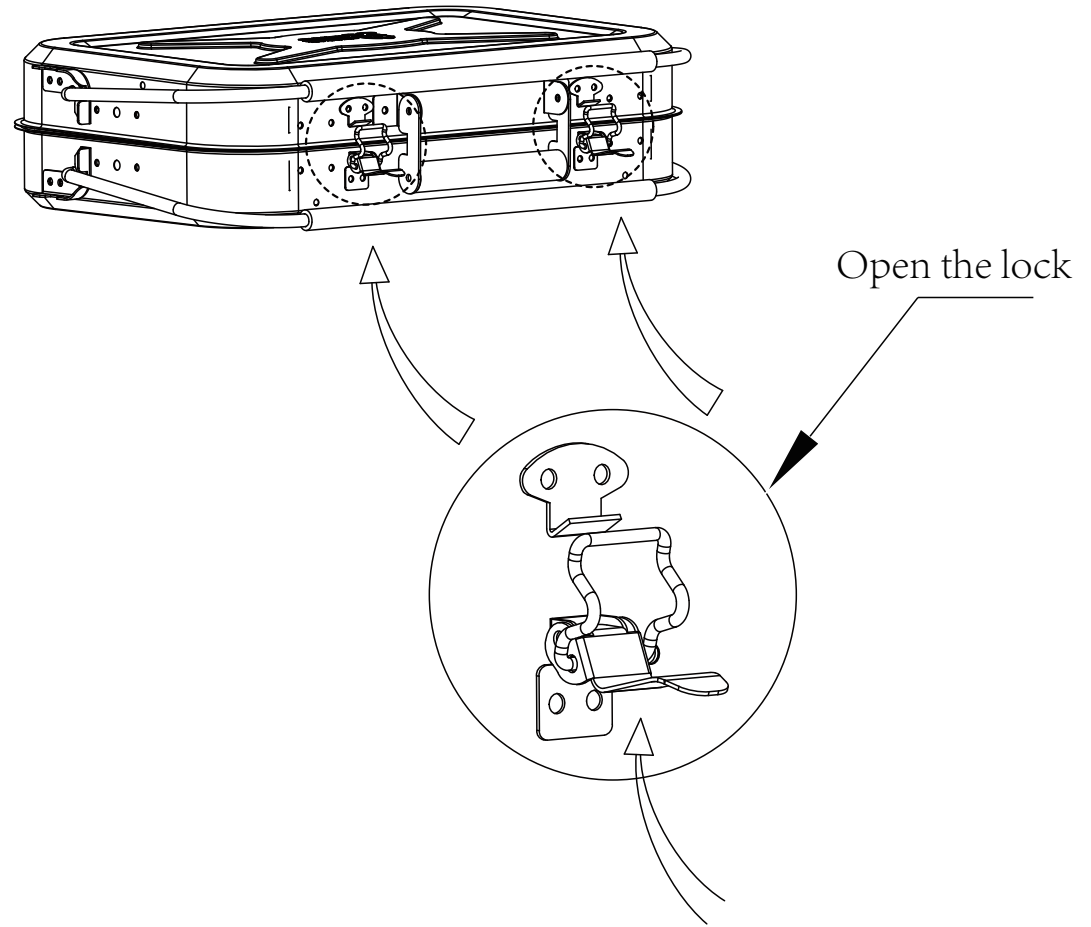

FIG3

Turn on the grill and remove all fittings from the grill

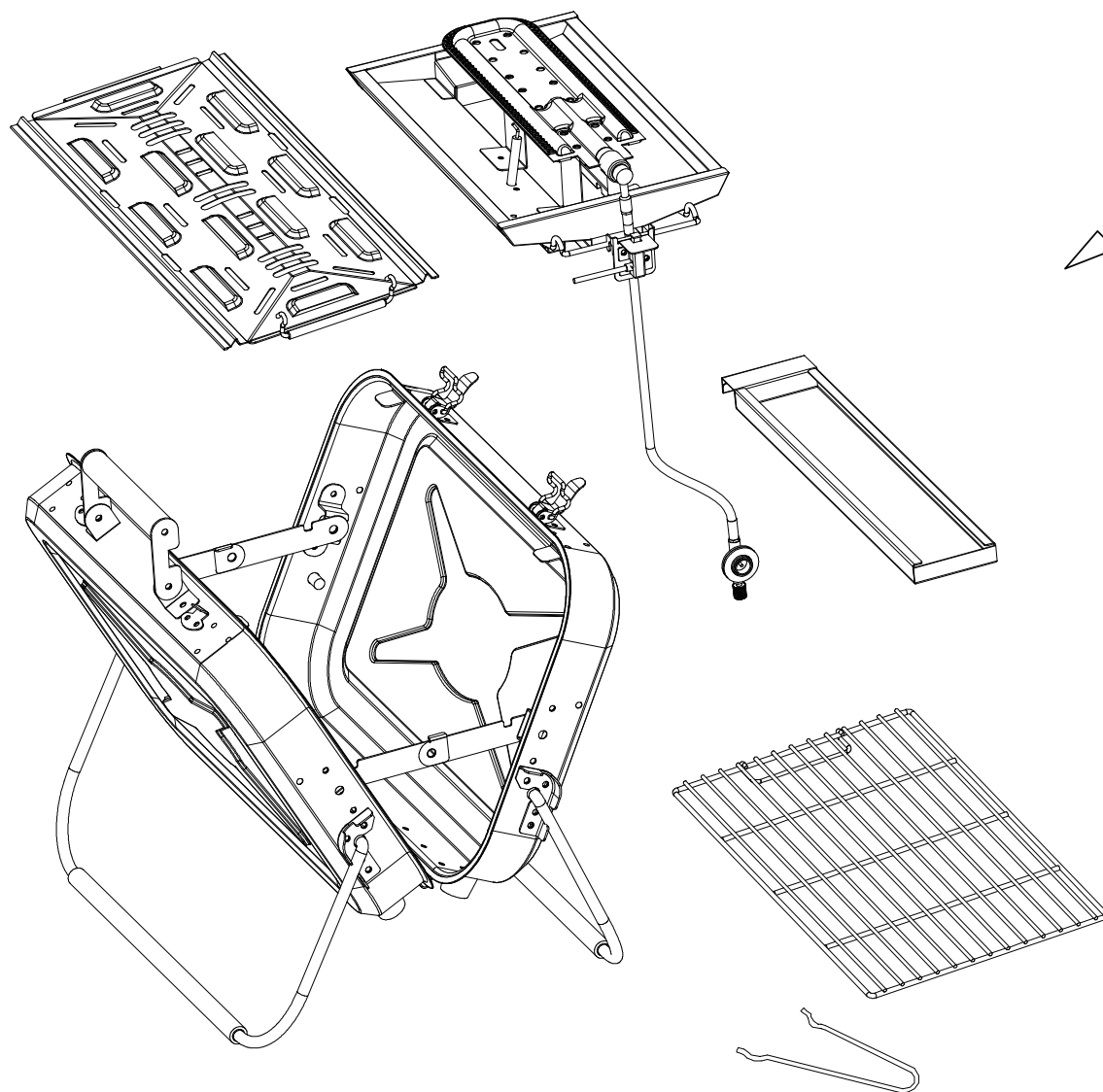

FIG4

According to the arrow in the figure below, rotate the furnace body foot support to open the clamp position, and then place the furnace body on the ground plane

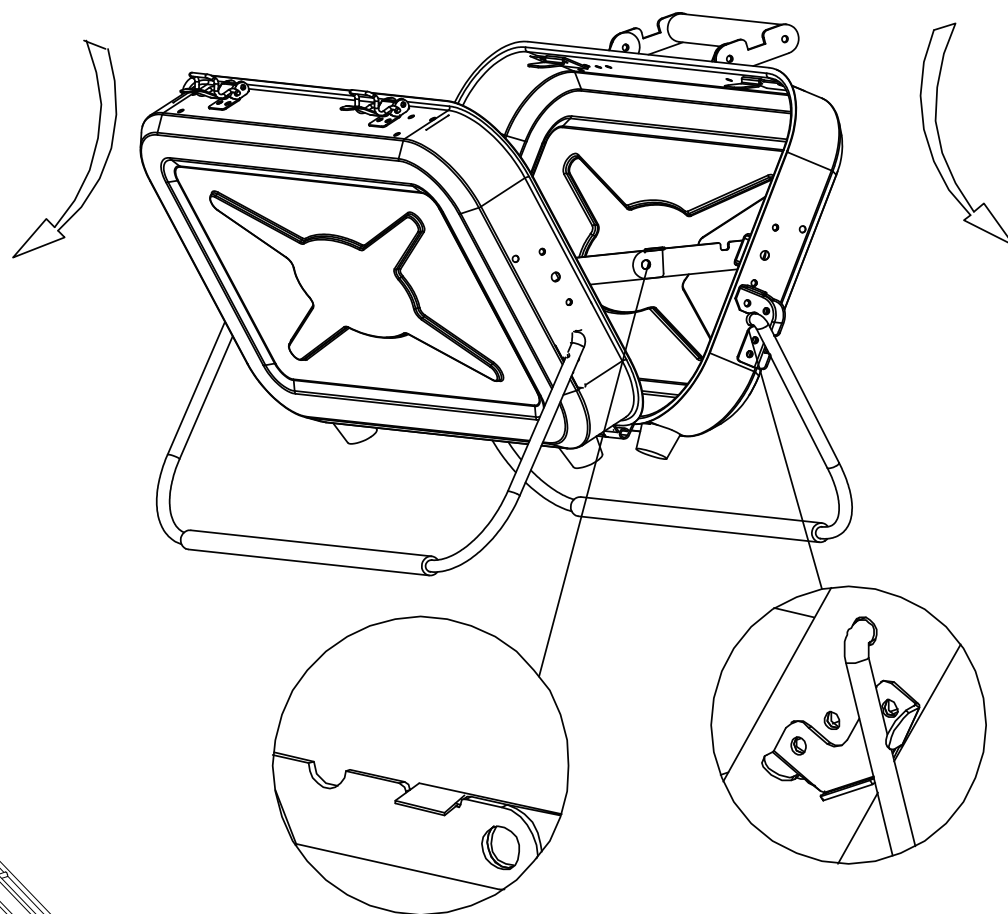

FIG5

Open the raised arc part of the foot support of the gas path assembly assembly and place it on figure below

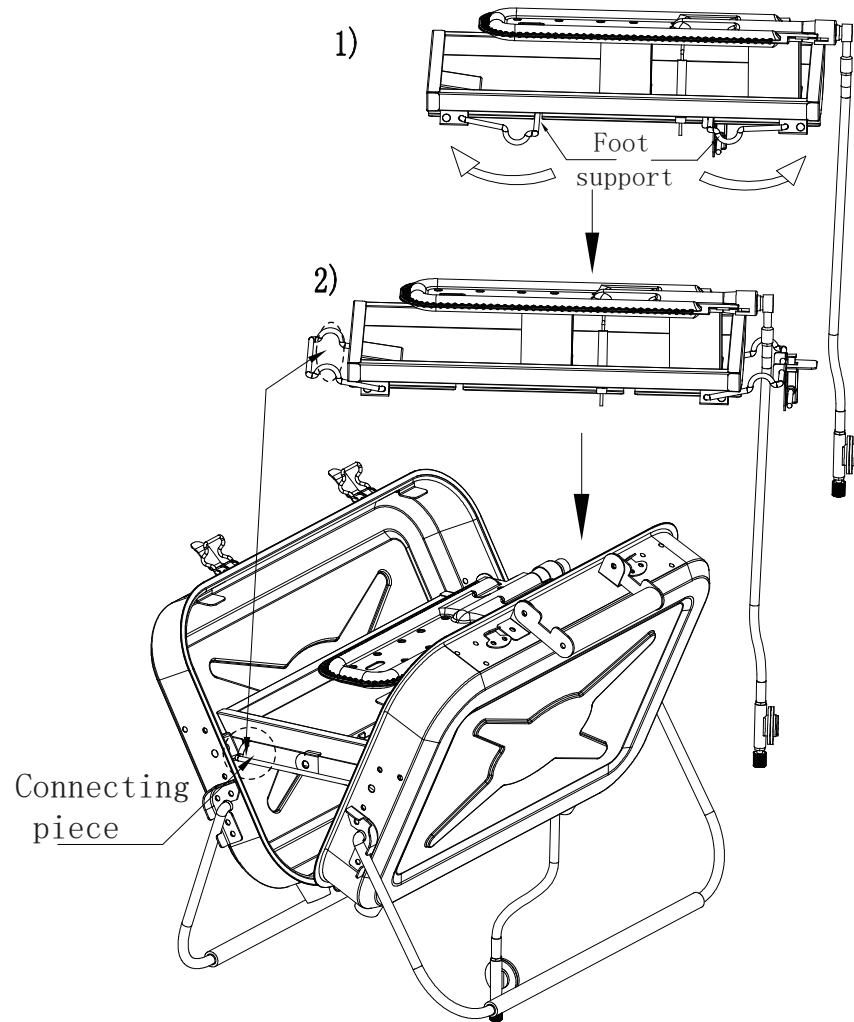

FIG6

Place the oil receiving box

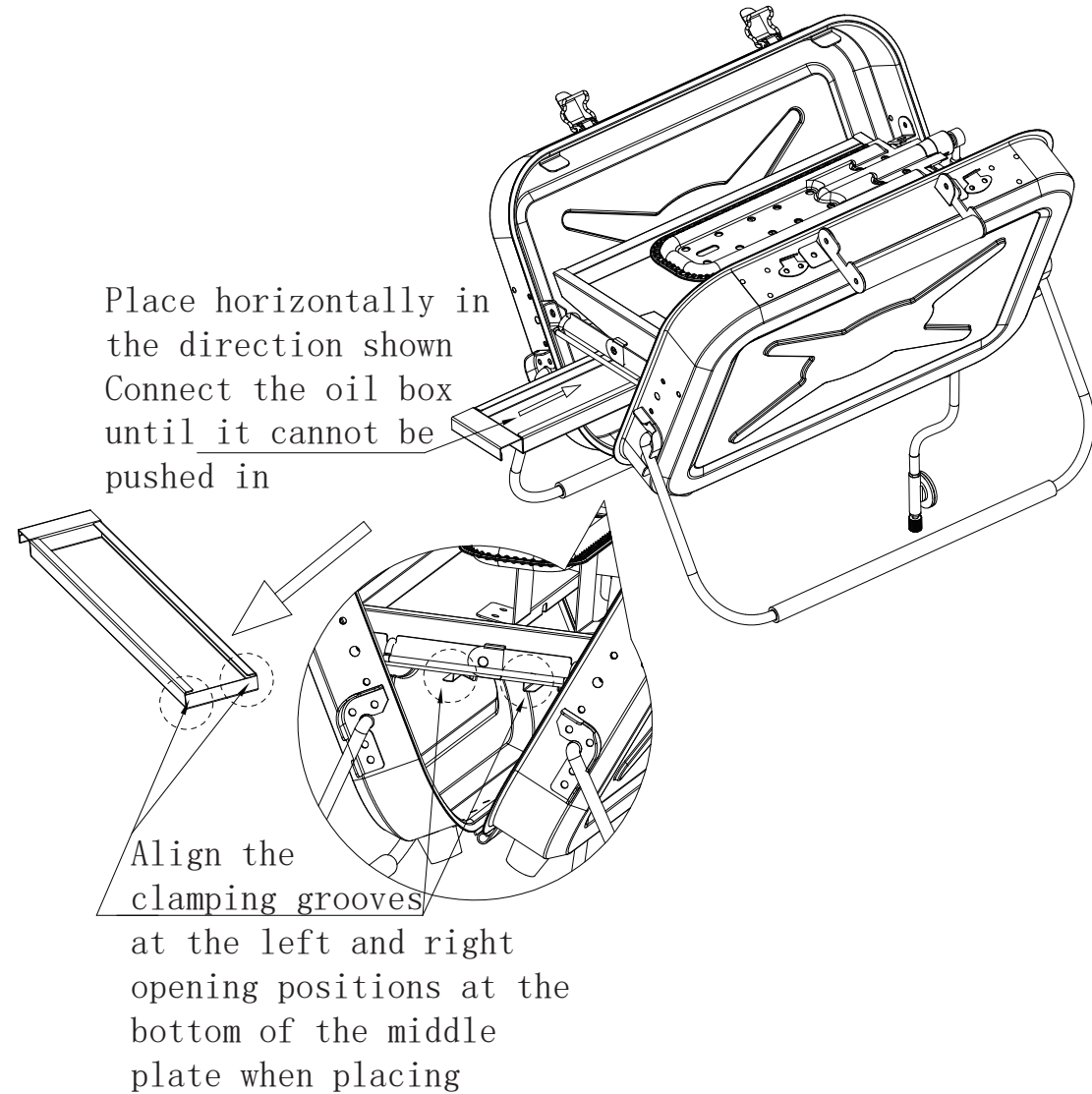

FIG7

Installation of baffle

Clip the circular arc position of the front end of the baffle (excluding the hook part) onto the fixing hook of the cooking grid in the direction shown in the figure, and don't move it.

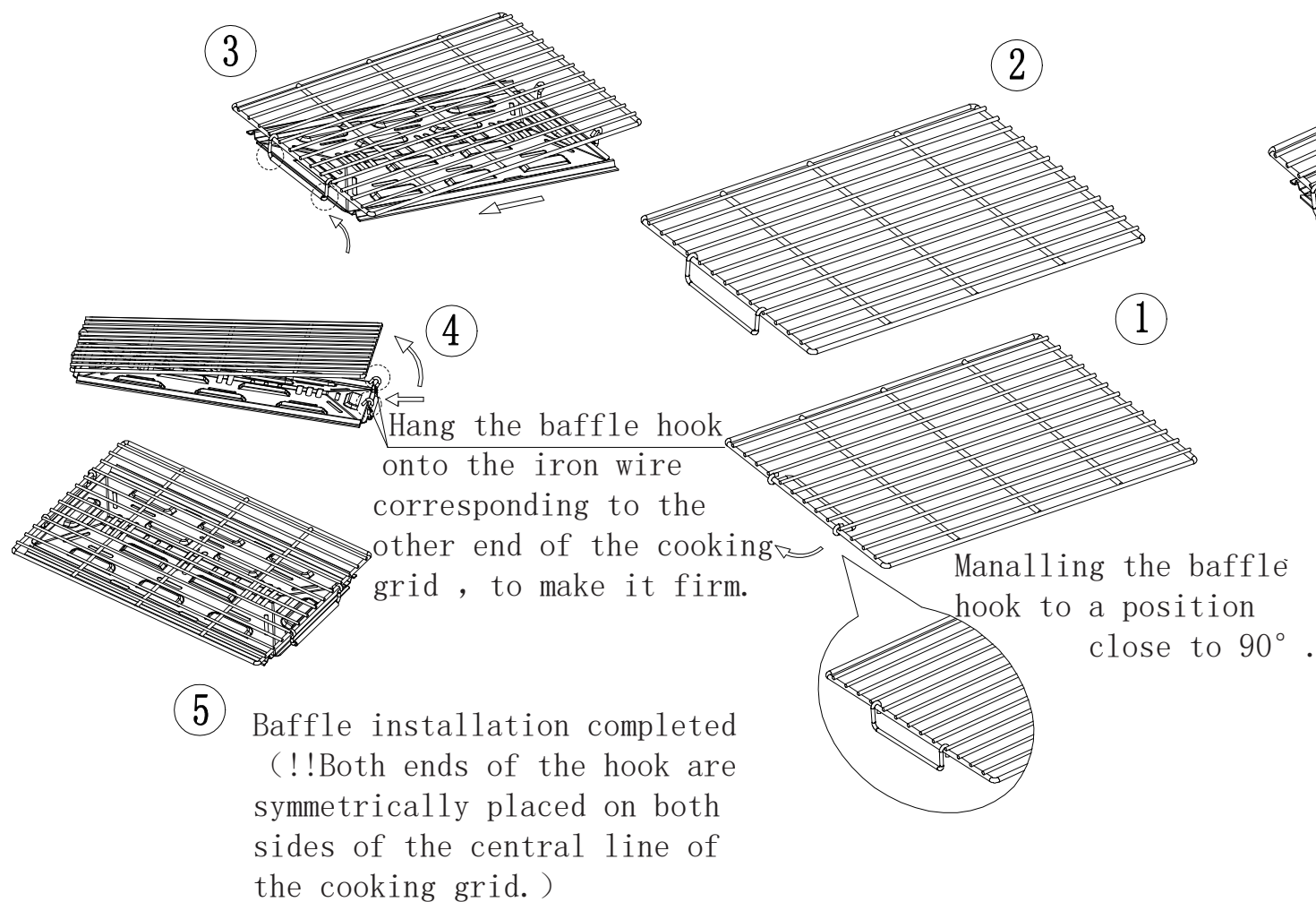

FIG8

Place the cooking grid

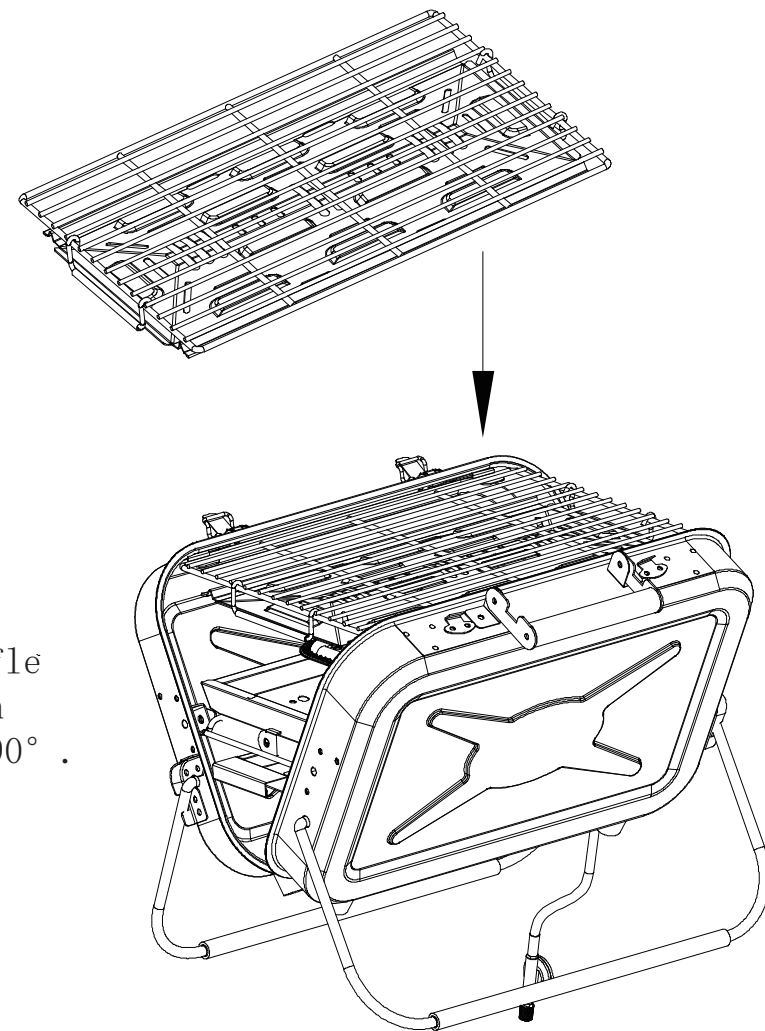
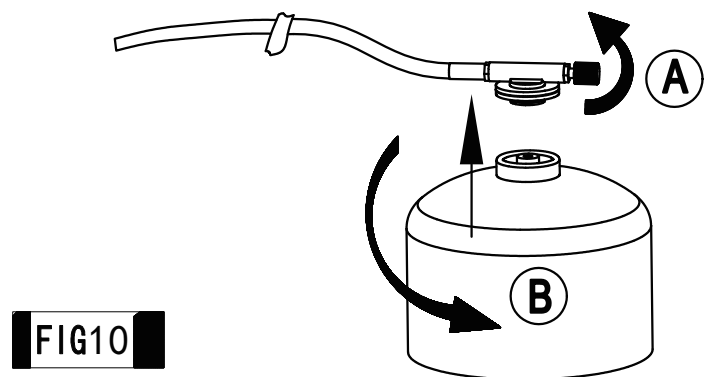
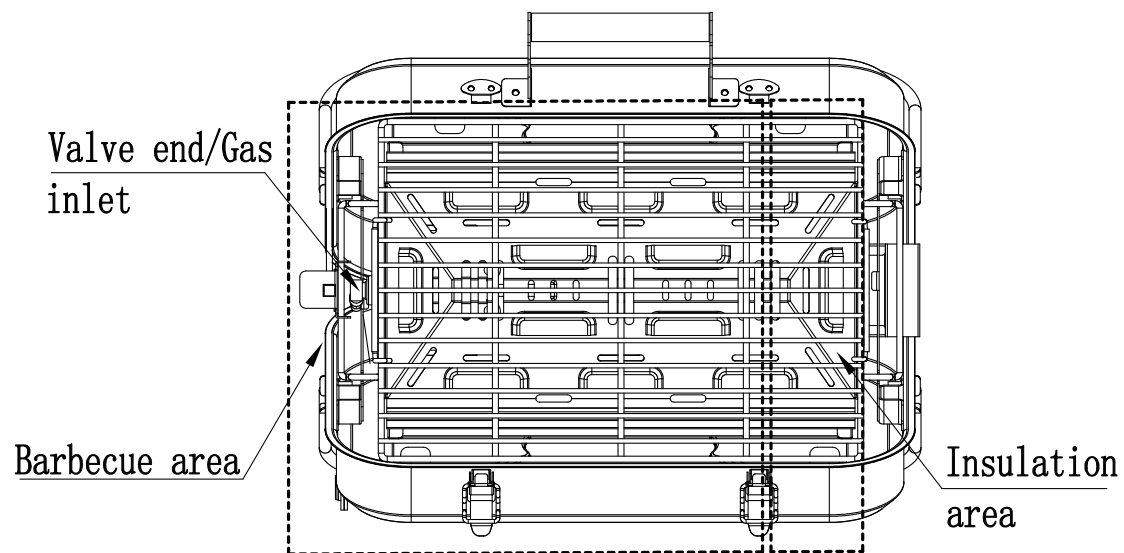
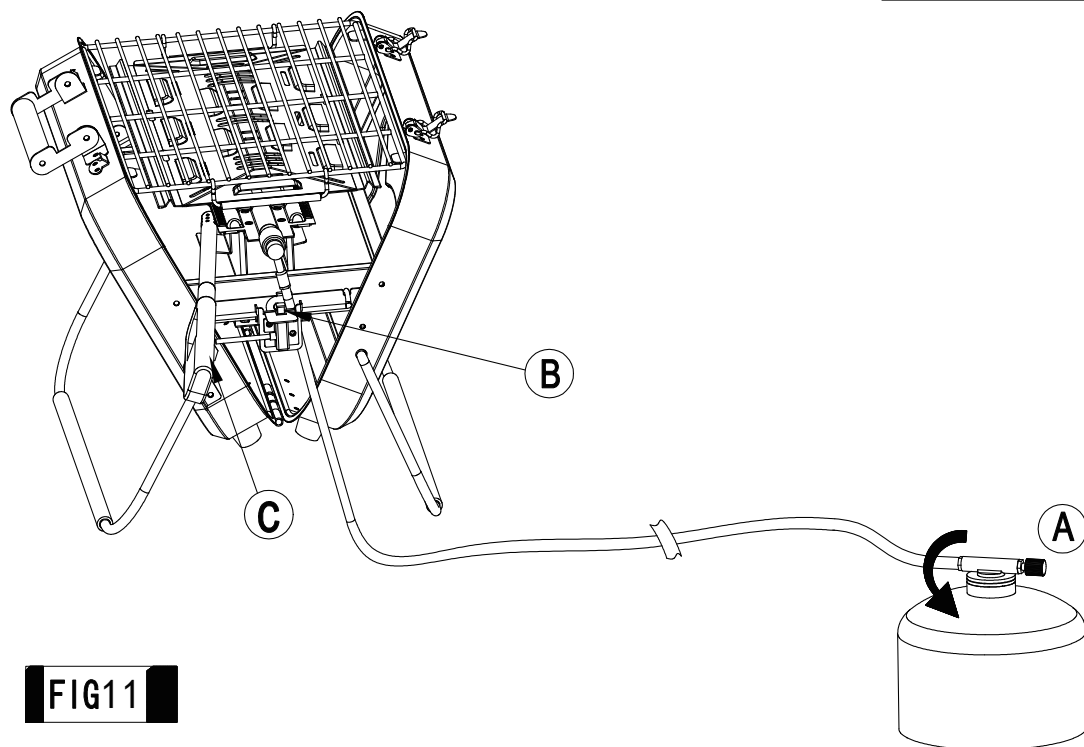

FIG9

Install the rotary gas tank to the valve assembly



Assembly completed



- Type of gas: Butane-Propane Mixture, Category: Direct Pressure
- Heat input: 5 kW , 357g/h, injector size: 0.35mm
- Manufacturer: Zhongshan Yunfeng Hardware Co., Ltd. Thank you for choosing the Yunfeng folding gas stove.
- Note: Unless otherwise stated. The following general terms “appliances/units/products/equipment/stoves/devices/machines” in this manual refer to product folding outdoor gas stoves.

I :Remember, be careful when using gas!!

- The following instructions are intended to enable you to use the folding gas stove correctly and safely.
- This(these) appliance(es) shall only be used with international 230g LPG cartridge, these gas cartridges should comply with EN 417. It may be hazardous to attempt to fit other types of gas containers. Use outdoors only!
- Check the sealing condition before using a new gas cylinder or connecting the gas cylinder to the equipment. Check that seals (between the appliance and the gas cartridge or gas cylinder) are in place and in good condition before connecting to the gas cartridge or gas cylinder.
- Do not use the appliance if it has damaged or worn seals.
- Do not use an appliance which is leaking, damaged or which does not operate properly.
- Before connecting gas cylinder, please read the instructions carefully and familiarize yourself with the equipment.
- Please read this instruction and the safety measures printed on the cylinder.
- Change the gas cartridge or gas cylinder outside and away from people.
- Failure to follow this instruction may put users and nearby people at risk.
- Please store the instructions in a safe place for reference when needed.
- This equipment can only be used with cylinders of the same type that match the certified valve and have an authorized safety

guarantee. Please use with the air tank opening facing upward. Attempting to install other types of gas cylinders or cylinders can pose a hazard.

- The company will not assume any responsibility when using any other capacity or type of brand gas cylinder.
- This equipment should only be used outdoors or in a well ventilated area, and should be kept at a good distance from any flammable materials. Keep away from hot/sparks/open flame surfaces.
- Do not use equipment that is leaking, malfunctioning, or damaged. Please return it to your retailer, who will contact the manufacturer on your behalf.
- It is prohibited to modify this equipment or use it for abnormal purposes. Do not modify this device.
- Do not use this product in caravans, cars, tents, cabins, sheds, boats, or in ships, or in any small enclosed areas.
- Do not use this product while sleeping, nor should it be used unattended.
- This product consumes fuel by burning or consuming oxygen, and may release certain hazardous substances and gases, such as carbon monoxide (CO).
- Carbon monoxide is a colorless and odorless gas. If the product is used in the above enclosed areas without proper ventilation, the generated carbon monoxide can cause flu like symptoms, discomfort, disease, and even death.

II :Expand and assemble the gas stove (Figures 1, 2, 3, 5, 6, 7, 8, 9)

- (1) Remove the package, take out the oven and open the lock as shown in Figure 1, 2, and 3.
- (2) Take out all accessories as shown in Figure 4.
- (3) Extend and level the stove body as shown in Fig 5
- (4) Install the gas circuit assembly as shown in Figure 6.
- (5) Place the oil receiving box as shown in Figure 7.
- (6) Install the fire shield as shown in Figure 8.

(7) Place the cooking grid as shown in Figure 9.

III: Safety measures

- It is prohibited to use your equipment at a distance of less than 120cm from walls or combustible materials.
- Place the equipment and gas cylinders on a stable and horizontal surface, and do not move them during use to avoid fires caused by the combustion of liquid butane rather than vaporized butane.
- If this occurs, turn off the control knob and reposition the device and/or filter element.
- **Do not use an air tank on an induction cooker table, stove, or a table with heat.**
- When replacing a gas tank, please close the gas stove and valves and keep away from ignition sources.
- Avoid excessive twisting of flexible gas pipes.
- Considering the power and stability of the gas stove flame, please do not use wind shielding facilities around the equipment. This behavior may damage your device rather than improve the performance of the product.
- When the barbecue food is ripe or nearly ripe, please turn it to a low heat or turn off the valve in time.

IV: Connect the gas cylinder (Figure 10)

- Check the sealing condition before using a new gas cylinder or connecting the gas cylinder to the equipment. Check that seals (between the appliance and the gas cartridge or gas cylinder) are in place and in good condition before connecting to the gas cartridge or gas cylinder.
- Do not use the appliance if it has damaged or worn seals.
- Do not use an appliance which is leaking, damaged or which does not operate properly.
- (Refer to: Removing gas Cylinder when existing cylinder is empty).

- When installing or removing gas cylinders, be sure to work in a well ventilated area, preferably outdoors. Do not work with flames, heat sources, or sparks (lit cigarettes, electrical equipment, etc.), and keep a certain distance from other people and flammable objects.

Due to the fact that the suitable gas cylinder is operated by a valve, it can be removed from the equipment for convenient transportation (even if it is not empty), and installed and adapted for use on this gas stove.

(1) As shown in Figure 10-A, turn the control knob ⑫ clockwise until it stops (the arrow points to "-"), and close the furnace body.

(2) Check the condition of the sealing ring ⑤. If the gasket is damaged, worn, or missing, do not use the device, and contact a after-sales representative to replace the gasket.

(3) As shown in Figure 10-B, tighten the gas cylinder (counter clockwise) and the fuel gas connector ⑬.

(4) Place the gas stove and gas cylinder on the same solid surface, and pay attention to keeping the flexible gas pipe away from the gas stove (flame).

The device is now ready to use.

If there is a leak on your appliance(smell of gas), take it outside immediately into a well ventilated flame free location where the leak may be detected and stopped. If you wish to check for leaks on your appliance, do it outside. Do not try to detect leaks using a flame, use soapy water.

V:Use of gas stoves

1-Ignition

Piezoelectric ignition

Before cooking, press the ignition button about 3 times in advance

to observe whether sparks hit the outer edge of the metal plate of the burner.

As shown in Figure 11-A, turn the control knob counterclockwise for about 1/4~1/3 turn (the arrow points to "+", turn it down properly when the cylinder is full or close to full) to turn on the gas.

As shown in Figure 11-B, repeatedly press the button until the gas stove is ignited.

Note: If the piezoelectric ignition fails, turn the control knob clockwise until it stops (the arrow points to "-"), and turn off the gas. Wait one minute before attempting a second attempt, or follow the ignition procedure below.

Ignition by ignition gun:

Place the ignition gun head close to the burner (Figure 11-C), rotate the control knob counterclockwise (the arrow points to "+"), gradually turn on the gas (Figure 11-A), and press the ignition gun switch.

2 - Cooking

After preheating, place the barbecue ingredients on the grill and place them in the center or on both sides of the burner. Adjust the gas flow rate so that the flame does not spill out of the baffle. Due to the open combustion of the product, there may be variations in the fire power at the end away from the gas inlet.

As shown in Figure 12, two temperature distribution areas are set at both ends of the cooking grid. One end near the valve inlet stove head is the barbecue area, and the other end is the insulation area.

When using, wear barbecue gloves to protect you from the effects of temperature.

3 - flameout

When you have finished cooking, turn the control knob clockwise until it stops (the arrow points to "-"), and turn off the gas.

VI: Remove the gas cylinder

Check whether the burner has been extinguished before disconnecting the cylinder. The gas cylinder can be disassembled even if it is not empty.

-Wait until the equipment cools down.

(1) Turn the control knob clockwise until it stops (the arrow points to “-”) and check whether the gas supply is completely turned off.

(2) Unscrew the cylinder from the gas connector ⑬.

Never dispose of the cylinder before making sure it is empty (shake the cylinder to hear the liquid sound).

VII: Folding gas stove

Important: 1) Please wait for the device to cool down.

2) When attempting to pull out, clean, or store, the oil receiving box should be taken out separately instead of taking out the air circuit assembly as a whole to prevent the oil receiving box from slipping out and causing some harm to people.

3) After use, it is recommended to clean the cooking grid and accessories with oil residue in time.

When cleaning accessories, please be careful not to use too much force, wipe the surface carefully, and try to avoid touching the ignition pin position as much as possible.

4) Gently place the accessories inside the machine, fold the feet and store them.

VIII: Maintenance, storage and problem solving

If a flashback occurs, turn off the product, allow it to cool (approximately 5 minutes), and then reignite.

If the flashback problem persists, please contact our after-sales service. (Contact information: 0760-86511159; Address: NO. 4 & NO. 10

Plant, XinCheng Creative Park, ShunJing Industrial District, BanFu Town, ZhongShan City, Guangdong Province, China)

After your device has completely cooled down

- (1) Remove the gas cylinder as described in Section 6.
- (2) Fold the gas cooker as described in Section 7.
- (3) Return the device to the bag. Note: If the equipment is still hot, it is strictly prohibited to put it into the bag.
- (4) **Keep equipment and gas cylinders in a cool, dry, and ventilated place, away from children. It is strictly prohibited to place them in the basement or cellar.**
- (5) If the cylinder contains gas but the device cannot ignite, do not attempt to repair it yourself, please return it to the retailer.
- (6) Ensure that there is sufficient air supply for combustion to avoid the generation of mixtures containing hazardous levels of unburned gases.
- (7) The piezoelectric igniter cannot ignite: Check whether the electrodes are damp, displaced, or whether the gas stove is used in a humid environment, or whether there are deposits on the electrodes. Dry the electrodes or ignite them with a torch.

Note: Touching parts can become very hot, please keep young children away from the device.

Safety precautions:



Warnings

- Read the instructions before using the appliance.
- CAUTION: accessible parts may become very hot. Keep young children away from the appliance.
- Although every effort has made in manufacture of your barbecue to remove any sharp edge, you should handle all components with care to avoid accidental injury.
- Improper use of this product may lead to product damage, personal injury, fire, and other accidents. Please be sure to use this product correctly based on carefully reading and fully understanding the User Manual.
- This product is only suitable for outdoor use, and it is strictly prohibited to use this product in narrow spaces such as tents or cars. During combustion, a large amount of oxygen is consumed, which may lead to accidents such as asphyxia or carbon monoxide poisoning due to lack of oxygen.
- This product is suitable for use in an environment of 18°C – 40 °C. Do not expose the air tank directly to the sun.
- Cooking utensils that can cover the entire size of the furnace are prohibited.
- After use, please remove the gas stove from the gas tank and keep the gas tank sealed to prevent gas leakage.
- Do not use this product in strong or hot winds, as strong winds can blow out flames, while hot winds may increase the pressure of the gas in the gas tank, causing an explosion.
- It is prohibited to use this product in flammable and explosive environments. Do not use it for other purposes than barbecue, including commercial purposes.
- The gas tank and gas type matching the connection method must be used. It is strictly prohibited to modify the gas pipe connector without permission. Unreliable connections

may cause accidents such as gas leakage or fire!

- This product is not intended for use in commercial applications.
- When using or just closing the folding stove, do not touch the burner, the stove frame, and the metal parts around the burner with your hands or other parts of your body to avoid scalding.
- Change the gas cartridge or gas cylinder outside and away from people.



Attention

- Please remove all packaging materials before using this product for the first time (including on the entire machine and accessories) . It is forbidden to use packaging materials as bedding for cookers to avoid fire accidents.
- When using, please place the folding stove on a horizontal and stable surface, and there should be no flammable substances (such as paper, plastic bags, etc.) under the folding stove. The distance between the gas tank and the folding furnace should be greater than 42cm, and the distance between the folding furnace and surrounding flammable materials should be greater than 120cm.
- When used for the first time, the baffle will have a certain degree of deformation or overall warping under thermal conditions, which is a process of releasing internal forces. Please continue the barbecue without removing the baffle from the grill.



Installation of cooking grid

- Don't install cooking grid in the burning working state of folding furnace to avoid scalding. The cooking grid should be installed stably.
- It is prohibited to install the baffle on the cooking grid in reverse, as this will make it unstable and cause functional failure.
- Don't dry burn the baffle for a long time to avoid product damage. The hook of the baffle should be stably hung at the center of the cooking grid, and both sides are opposite to the other end.
- Don't place load-bearing objects on the grill, such as rice cookers, boiling utensils, etc.